

# Comparative analysis of the enantiomers of nefopam in antinociceptive tests.

**Author:** BenchChem Technical Support Team. **Date:** December 2025

## Compound of Interest

Compound Name: Nefopam

Cat. No.: B083846

[Get Quote](#)

## A Comparative Analysis of Nefopam Enantiomers in Antinociceptive Tests

A detailed guide for researchers and drug development professionals on the differential antinociceptive effects of (S)- and (R)-**nefopam**, supported by experimental data and protocols.

**Nefopam**, a centrally acting, non-opioid analgesic, is clinically administered as a racemic mixture of its two enantiomers: (S)-**nefopam** and (R)-**nefopam**.<sup>[1][2]</sup> While the racemic form has demonstrated efficacy in managing mild to moderate pain, emerging research highlights significant differences in the pharmacological activity of the individual enantiomers.<sup>[1][3]</sup> This guide provides a comparative analysis of the antinociceptive properties of (S)- and (R)-**nefopam**, presenting key experimental findings, detailed methodologies, and a summary of the underlying mechanisms of action.

## Comparative Antinociceptive Efficacy

Studies have consistently demonstrated that the (+)-enantiomer, (S)-**nefopam**, is significantly more potent in its analgesic effects than the (-)-enantiomer, (R)-**nefopam**.<sup>[1][3]</sup> This difference in potency has been observed across various preclinical models of pain.

## Quantitative Data Summary

The following table summarizes the comparative efficacy of **nefopam** enantiomers in common antinociceptive tests.

Test	Animal Model	Route of Administration	Enantiomer	ED <sub>50</sub> (mg/kg) or Effect	Source
Hot-Plate Test	Mice	Intraperitoneal	(+)-Nefopam	More potent than (-)-nefopam	[3]
Mice	Intracerebroventricular	(+)-Nefopam	More potent than (-)-nefopam	[3]	
Mice	Intrathecal	(+)-Nefopam	More potent than (-)-nefopam	[3]	
Formalin Test	Mice	Intraperitoneal	(+)-Nefopam	More potent than (-)-nefopam	[1][3]
Tail-Flick Test	Mice	Intraperitoneal	(+/-)-Nefopam	Weak but significant elevation of response latencies	[3]
Rats	Not specified	Neither enantiomer	No substantial activity	[1]	

## Mechanism of Action: A Tale of Two Enantiomers

The primary mechanism underlying **nefopam**'s analgesic effect is the inhibition of monoamine reuptake, specifically of serotonin (5-HT), norepinephrine (NE), and dopamine (DA).[4][5] This action increases the concentration of these neurotransmitters in the synaptic cleft, thereby enhancing their modulation of pain transmission pathways.[5] The differential potency of the enantiomers is believed to stem from their varying affinities for the monoamine transporters.

Beyond monoamine reuptake inhibition, **nefopam** has been shown to interact with voltage-gated sodium and calcium channels, which may further contribute to its antinociceptive effects by reducing neuronal excitability.[5] The analgesic action of **nefopam** is exerted at both spinal and supraspinal levels, activating descending pain-modulating pathways.[3]

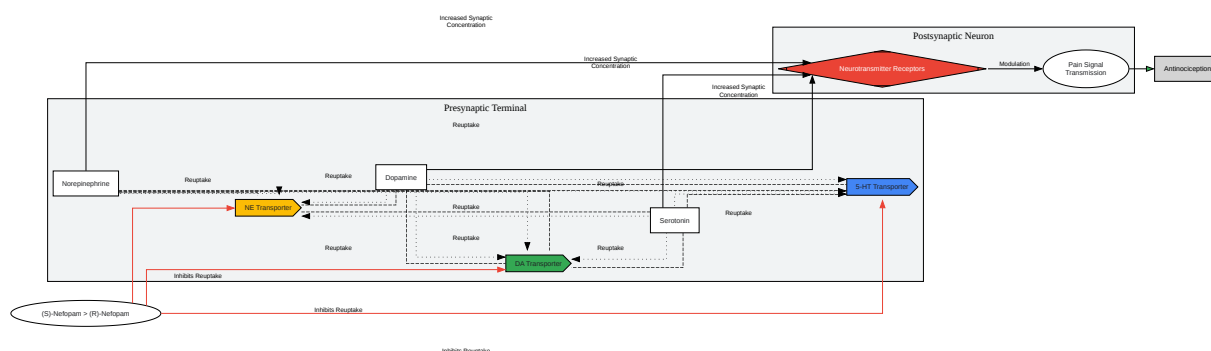

[Click to download full resolution via product page](#)

*Fig. 1: Proposed signaling pathway for **nefopam**'s antinociceptive action.*

## Experimental Protocols

Detailed methodologies are crucial for the replication and validation of scientific findings. Below are the protocols for key antinociceptive tests used in the evaluation of **nefopam** enantiomers.

### Hot-Plate Test

This test assesses the response to a thermal stimulus, primarily reflecting supraspinal mechanisms of analgesia.

- Apparatus: A commercially available hot-plate apparatus with the surface temperature maintained at a constant  $55 \pm 0.5^{\circ}\text{C}$ .
- Procedure:
  - Animals (typically mice) are individually placed on the heated surface.
  - The latency to the first sign of nociception (e.g., licking a hind paw, jumping) is recorded.
  - A cut-off time (e.g., 30-60 seconds) is established to prevent tissue damage.
- Drug Administration: **Nefopam** enantiomers or vehicle are administered via the desired route (e.g., intraperitoneal, intracerebroventricular) at a predetermined time before the test.
- Data Analysis: The mean latency to response is calculated for each treatment group and compared. An increase in latency indicates an antinociceptive effect.

### Formalin Test

The formalin test is a model of tonic pain that has two distinct phases, allowing for the differentiation of analgesic effects on acute and inflammatory pain.

- Procedure:
  - A small volume (e.g., 20  $\mu\text{L}$ ) of a dilute formalin solution (e.g., 1-5%) is injected subcutaneously into the plantar surface of a hind paw of the animal (e.g., mouse or rat).
  - The animal is then placed in an observation chamber.

- The total time spent licking or biting the injected paw is recorded for two distinct periods: the early phase (0-5 minutes post-injection), representing direct nociceptor activation, and the late phase (15-30 minutes post-injection), reflecting inflammatory processes.
- Drug Administration: Test compounds are administered prior to the formalin injection.
- Data Analysis: The duration of licking/biting is compared between treated and control groups for both phases. A reduction in this duration signifies antinociception.

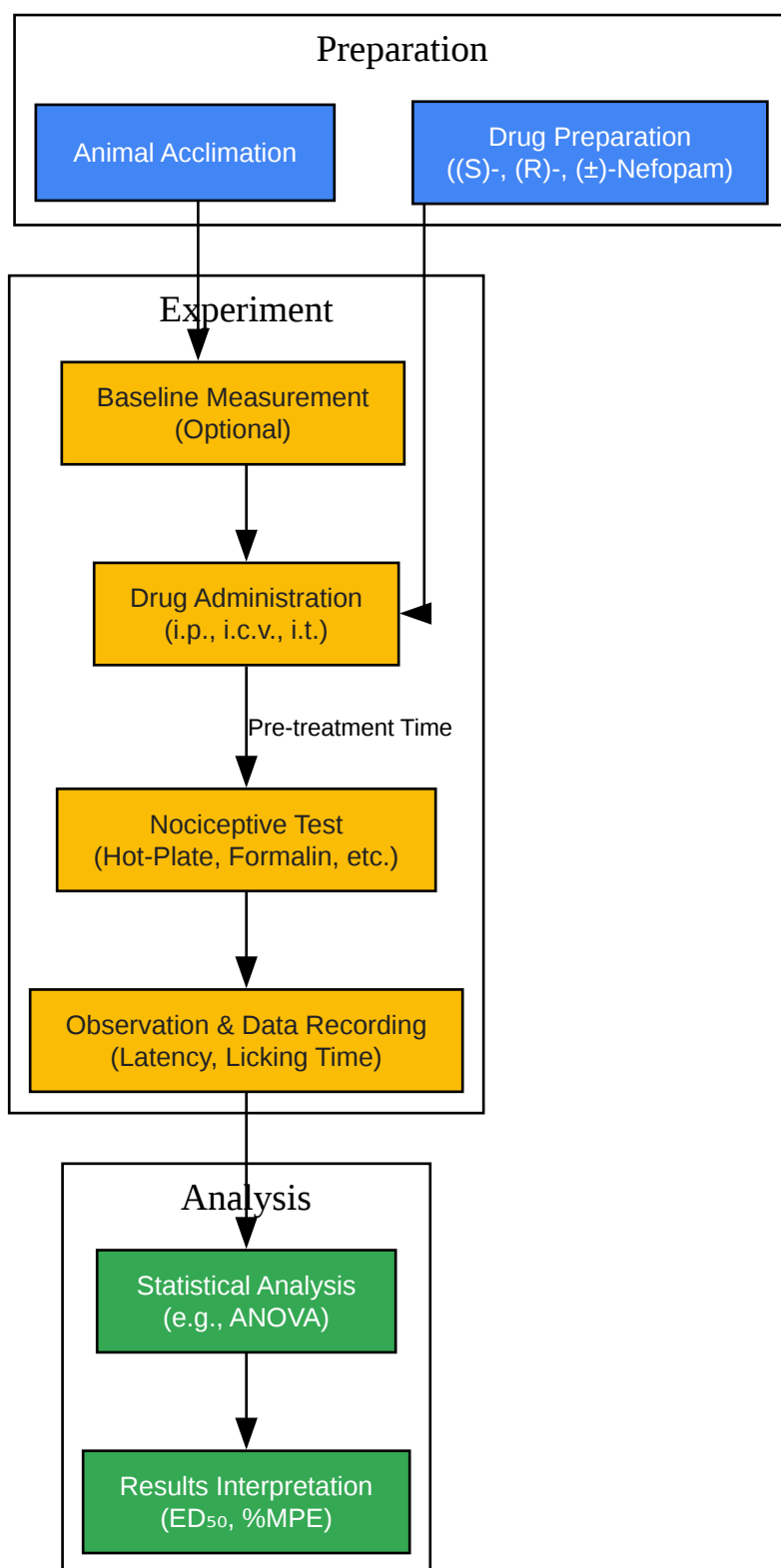

[Click to download full resolution via product page](#)

*Fig. 2: General experimental workflow for antinociceptive testing.*

## Tail-Flick Test

This assay measures the latency of a reflexive withdrawal of the tail from a thermal stimulus and is primarily indicative of spinal mechanisms of analgesia.

- Apparatus: A tail-flick analgesia meter that focuses a beam of high-intensity light on the animal's tail.
- Procedure:
  - The animal (typically a rat or mouse) is gently restrained.
  - The light beam is focused on a specific portion of the tail.
  - The time taken for the animal to flick its tail away from the heat source is automatically recorded.
  - A cut-off time is set to prevent tissue damage.
- Drug Administration: The test compounds are administered before the test.
- Data Analysis: The latency to tail flick is compared across treatment groups. An increased latency suggests an antinociceptive effect. It is noteworthy that in some studies, **nefopam** enantiomers did not show significant activity in the rat tail-flick test.[\[1\]](#)

## Conclusion

The available evidence strongly indicates that the antinociceptive effects of **nefopam** are primarily driven by the (S)-enantiomer. This stereoselectivity in action highlights the importance of chiral considerations in drug development and pharmacology. While racemic **nefopam** is an effective analgesic, the superior potency of (S)-**nefopam** suggests that an enantiomerically pure formulation could potentially offer an improved therapeutic profile, possibly with a better side-effect profile at equianalgesic doses. Further research is warranted to fully elucidate the clinical implications of these preclinical findings.

**Need Custom Synthesis?**

BenchChem offers custom synthesis for rare earth carbides and specific isotopic labeling.

Email: [info@benchchem.com](mailto:info@benchchem.com) or [Request Quote Online](#).

## References

- 1. Nefopam enantiomers: preclinical pharmacology/toxicology and pharmacokinetic characteristics in healthy subjects after intravenous administration - PubMed [pubmed.ncbi.nlm.nih.gov]
- 2. Rediscovery of Nefopam for the Treatment of Neuropathic Pain - PMC [pmc.ncbi.nlm.nih.gov]
- 3. Antinociceptive effects of (+/-)-, (+)- and (-)-nefopam in mice - PubMed [pubmed.ncbi.nlm.nih.gov]
- 4. Antinociceptive Effect of Intrathecal Nefopam and Interaction with Morphine in Formalin-Induced Pain of Rats - PMC [pmc.ncbi.nlm.nih.gov]
- 5. What is the mechanism of Nefopam Hydrochloride? [synapse.patsnap.com]
- To cite this document: BenchChem. [Comparative analysis of the enantiomers of nefopam in antinociceptive tests.]. BenchChem, [2025]. [Online PDF]. Available at: [https://www.benchchem.com/product/b083846#comparative-analysis-of-the-enantiomers-of-nefopam-in-antinociceptive-tests]

---

**Disclaimer & Data Validity:**

The information provided in this document is for Research Use Only (RUO) and is strictly not intended for diagnostic or therapeutic procedures. While BenchChem strives to provide accurate protocols, we make no warranties, express or implied, regarding the fitness of this product for every specific experimental setup.

**Technical Support:** The protocols provided are for reference purposes. Unsure if this reagent suits your experiment? [[Contact our Ph.D. Support Team for a compatibility check](#)]

**Need Industrial/Bulk Grade?** [Request Custom Synthesis Quote](#)



# BenchChem

Our mission is to be the trusted global source of essential and advanced chemicals, empowering scientists and researchers to drive progress in science and industry.

## Contact

Address: 3281 E Guasti Rd

Ontario, CA 91761, United States

Phone: (601) 213-4426

Email: [info@benchchem.com](mailto:info@benchchem.com)